

# SIGNAL TIMINGS

PHASE 1	Red: 5 Seconds	Green: 35 Seconds
PHASE 2	Red: 5 Seconds	Green: 35 Seconds

QTY: 2 REF: 7022 Advance warning of uncontrolled joining traffic	
QTY: 1 REF: 7021 Advance warning of PTS control on main road ahead	
QTY: 2 REF: 610 Keep /right	
QTY: 1 REF: 610 Keep left	
QTY: 2 REF: 7011 When Red Light Shows Wait Here	
QTY: 2 REF: 518 Single file traffic	
QTY: 1 REF: 517 Road narrows on one side only ahead (variant)	
QTY: 2 REF: 543 Traffic signals ahead	
QTY: 2 REF: 7001 Road works ahead	
QTY: 1 REF: 517 Road narrows on one side only ahead	

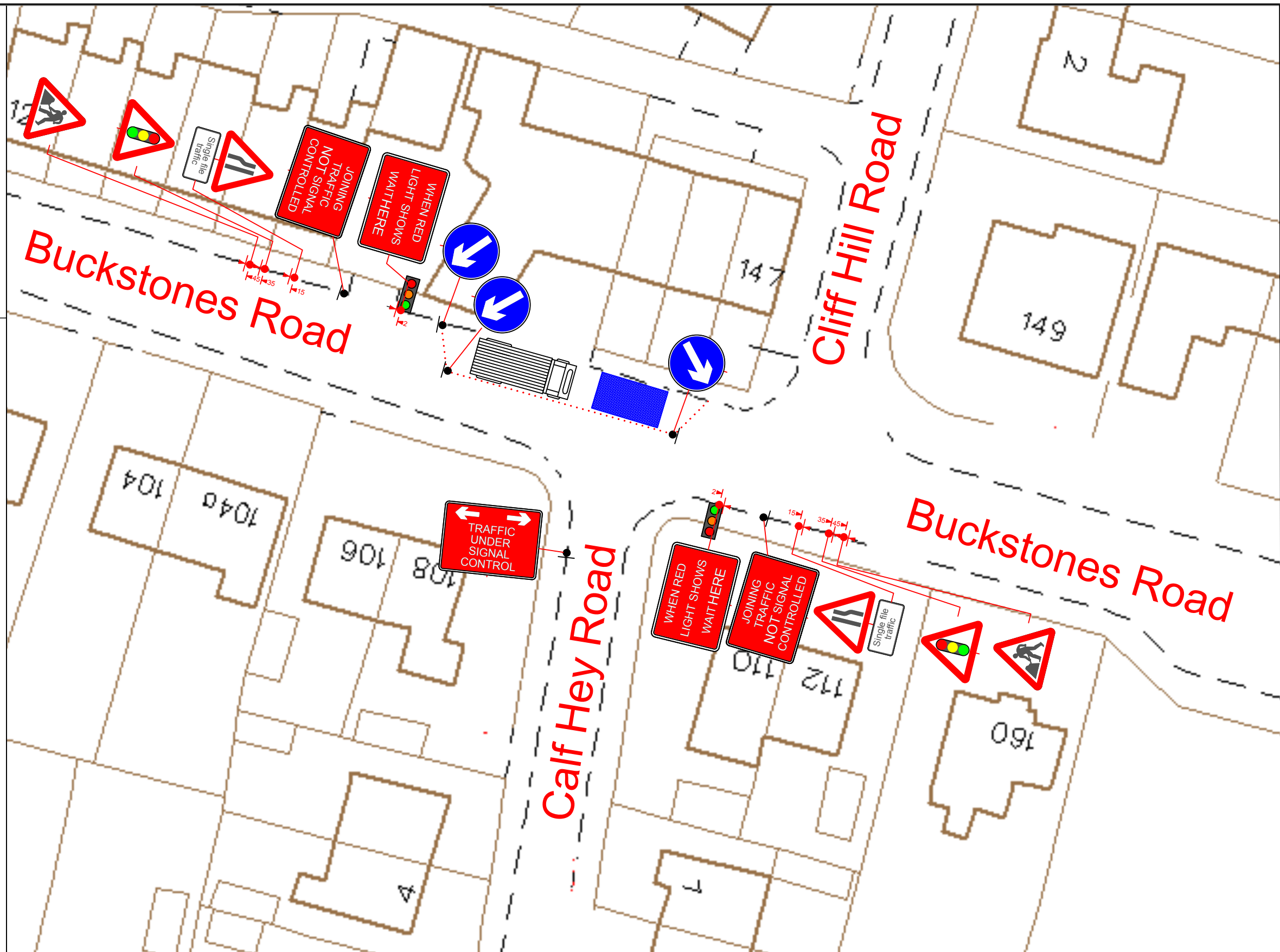

<b>DETAILS</b> Single file traffic cones, spacing 1.5m. Dual carriageway 40mph or less - 450mm traffic cones, spacing 1.5m. Dual carriageway 50mph or more - 750mm traffic cones, spacing 1.5m. Notes: 1) During darkness, warning lights to BS EN 12352:2006 should be provided in accordance with Table A1.3 (Appendix 1). 2) On motorways and A66, AP-roads with hard shoulders, 1m cones will be required for both standard and relocation works for hard shoulders and the facing wall of lane changes.	<b>DETAIL C1</b> Single/Dual carriageway 40mph or less - 450mm traffic cones. Single/Dual carriageway 50mph or more - 750mm traffic cones. Notes: 1) During darkness, warning lights to BS EN 12352:2006 should be provided in accordance with Table A1.3 (Appendix 1). 2) For relocation to Detail C1 see Table A1.3 (Appendix 1).	<b>DETAIL C2</b> Single/Dual carriageway 40mph or less - 450mm traffic cones. Single/Dual carriageway 50mph or more - 750mm traffic cones. Notes: 1) During darkness, warning lights to BS EN 12352:2006 should be provided in accordance with Table A1.3 (Appendix 1). 2) For relocation to Detail C1 see Table A1.3 (Appendix 1).	TRAFFIC CONE DIVERSION ROUTE WORKING AREA	LOCATION OF SIGN LOCATION OF SIGNAL HEAD
--	--	--	---	---

**Address:**  
Buckstones Road  
Calf Hey Road  
Oldham OL2 8DW

**Traffic Management:**  
2 Way Signals  
All Signals/TM to be assessed on site  
and may be altered to suit  
Traffic, Location and Conditions

**Drawing No:**  
3077-0516  
**Agent:**  
Edward Reeves

**Drawn By:**  
Jade Bennett  
**Date:** 18-05-2016

**Checked By:**  
Lloyd Simpson  
**Date:** xxxxxxxx

**IF YOU HAVE ANY QUERIES PLEASE CONTACT:**  
lloyd.simpson@amey.co.uk - 07789170274  
paul.simpson@amey.co.uk - 07976343797

Amey Traffic Management  
8 FACTORY LANE  
HARPURHEY  
MANCHESTER  
M9 8AB  
Original drawing size A3 - NTS

