

**KEY:**

- Sign
- Work Area
- Diversion Route
- Diversion Route
- Manhole
- Cone

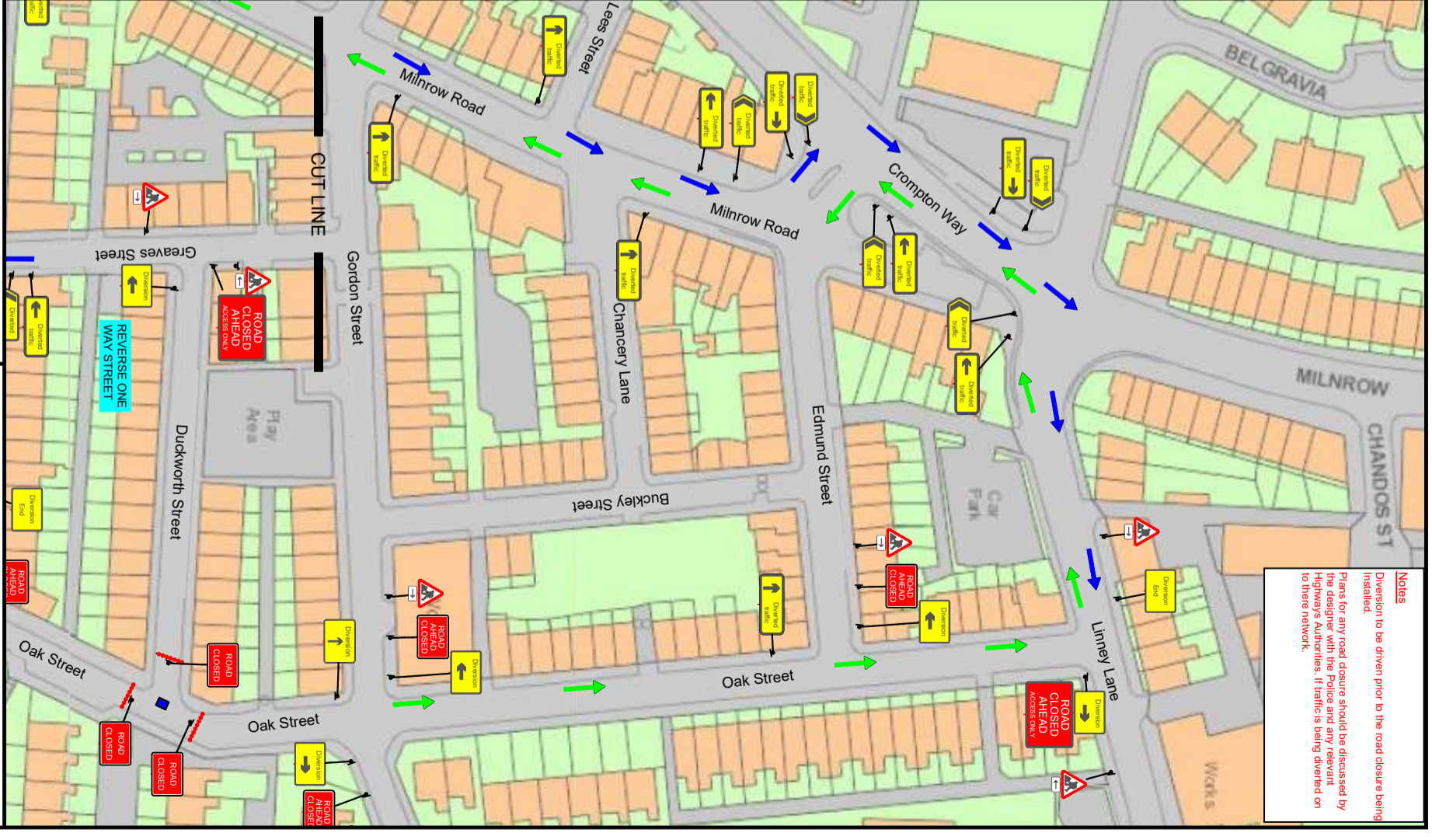
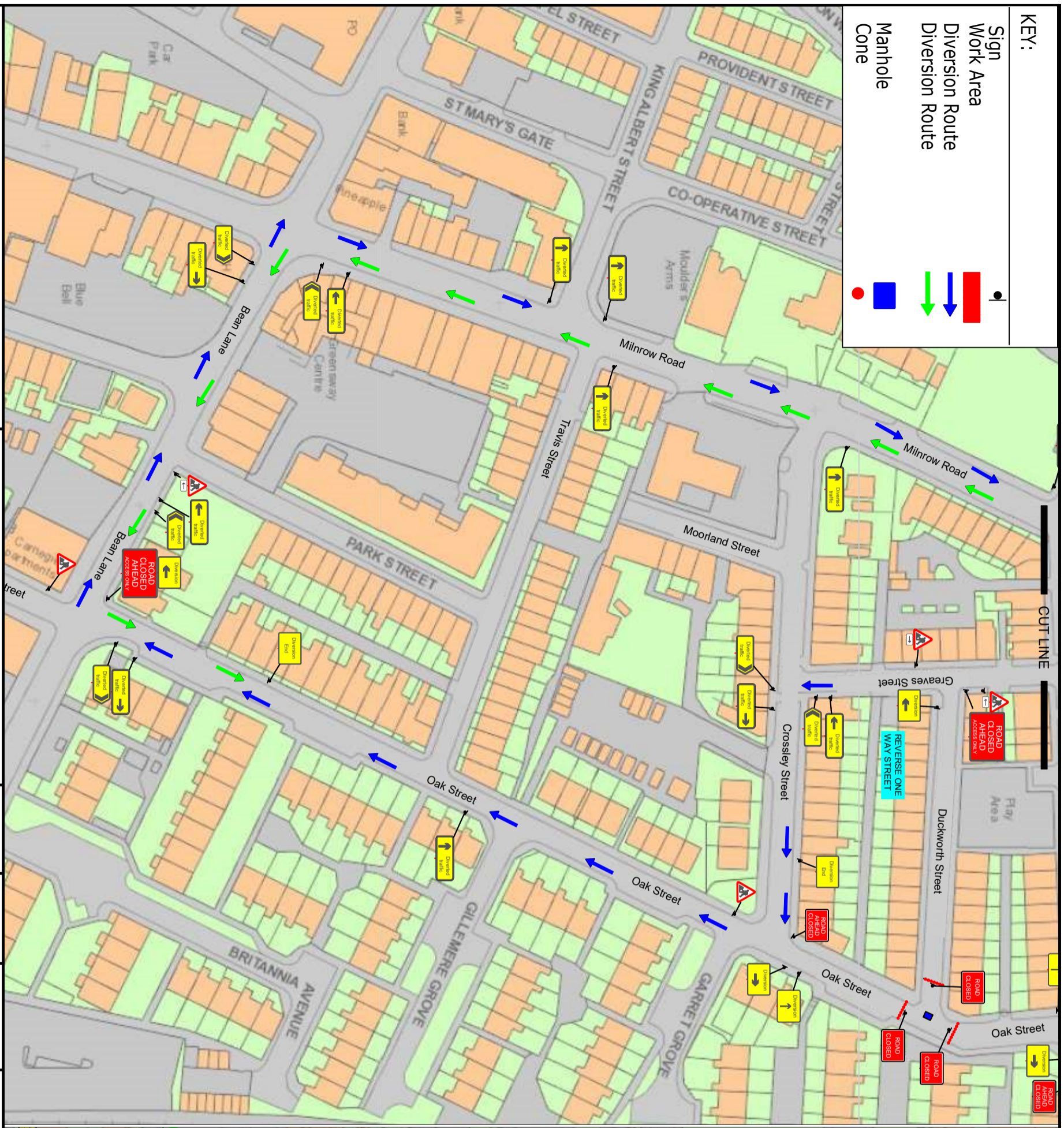

**Notes**  
 Diversion to be driven prior to the road closure being installed.  
 Plans for any road closure should be discussed by the designer with the Police and any relevant Highways Authorities. If traffic is being diverted on to their network.

**Sapphire**  
 TRAFFIC MANAGEMENT

Sapphire Utility Solutions  
 481 Ranglet Road  
 Preston

Issue: 1	Date
Drawn	03/12/2021
Checked	03/12/2021
Approved	03/12/2021

Client: Sapphire Utility  
 Site: 17, Duckworth Street  
 Shaw, Oldham  
 OL2 8ET  
 Project: Road closure diversion  
 Original drawing size A4 - NTS

Drawing No : SA-1245851  
 Works Ref No: WO 00709444

This drawing is the property of Sapphire TM Ltd. reproduction in part or in whole is prohibited without prior permission from Sapphire Utility Ltd.